

# NEGARA BRUNEI DARUSSALAM

## AIP SUPPLEMENT

TEL : 673-2-331730  
AFS : WBSBYNYX  
FAX : 673-2-331706  
673-2-331730  
E-mail: [ais.brunei@dca.gov.bn](mailto:ais.brunei@dca.gov.bn)  
Website: [www.dca.gov.bn](http://www.dca.gov.bn)

AERONAUTICAL INFORMATION SERVICE  
DEPARTMENT OF CIVIL AVIATION  
MINISTRY OF TRANSPORT AND  
INFOCOMMUNICATIONS  
BRUNEI INTERNATIONAL AIRPORT, BB2513

02/24  
12 FEB

### BRUNEI INTERNATIONAL AIRPORT REHABILITATION WORKS OF AIRFIELD PAVEMENT WORK SCHEDULE

#### 1. INTRODUCTION

- 1.1 The airfield pavement at Brunei International Airport is undergoing the second stages of rehabilitation works. The works involve the rehabilitation of the Southern Parallel Taxiway and partial works to the Western Parallel Taxiway. The working areas for the rehabilitation are provided in Attachment "1" of this AIP Supplement.

#### 2. PURPOSE

- 2.1 The purpose of this AIP Supplement is to notify the aviation industry of the schedule and the extent of the work areas due to construction activities on the aircraft maneuvering movement areas, as well as the changes and restrictions on the maneuvering movement areas at the Taxiways of Brunei International Airport.
- 2.2 Construction works are expected to take Twenty-Four (24) months.

#### 3. WORK PHASES AND TEMPORARY CLOSURE OF MOVEMENT AREAS

- 3.1 The tentative work activities are divided into 4 stages as per the general sequence outlined in Table 3.1. Refer to Appendix 1 – Appendix 4 of this Supplement for details. The duration contained in Table 3.1 is indicative and some works occur concurrently. Exact dates and times will be circulated by NOTAM with reference to this supplement.
- 3.2 There will be no Aerodrome Closure Period (ACP) during this rehabilitation works. Any changes to the any closure times if necessary will be circulated through NOTAM.

**Table 3.1 Work Phases and Temporary Closure of Movement Areas**

<b>Stages</b>	<b>Location</b>	<b>Duration</b>	<b>Activity</b>
Stage 1	Southern Parallel Taxiway - Taxiway Link E5 to Taxiway Link E4	240 days (01/02/2024 to 30/09/2024)	<ul style="list-style-type: none"><li>- Partial closure of Southern Parallel Taxiway</li><li>- Rehabilitation of PCC pavement</li><li>- Drainage Works</li><li>- AGL Works</li></ul>
Stages 2	Taxiway E4 Link to EG 2	90 days (01/10/2024 to 31/12/2024)	<ul style="list-style-type: none"><li>- Rehabilitation of PCC pavement towards EG2</li><li>- Construction of access road to Runway from Airport Fire Service Station</li><li>- Drainage Works</li><li>- AGL Works</li></ul>
Stages 3	EG1 to Taxiway Link E3	80 Days (01/01/2025 to 30/04/2025)	<ul style="list-style-type: none"><li>- Closure of EG 1 to Taxiway Link E3</li><li>- Rehabilitation Works for PCC Pavement</li><li>- AGL Works</li></ul>
Stages 4	Western Parallel Taxiway near Taxiway Link W2	210 days (01/05/2025 to 31/10/2025)	<ul style="list-style-type: none"><li>- Rehabilitation works for PCC pavement</li><li>- AGL Works</li></ul>

#### **4. CONSTRUCTION WORKING HOURS FOR SOUTHERN PARALLEL TAXIWAY AND TAXIWAY LINKS**

##### **STAGE 1: SOUTHERN PARALLEL TAXIWAY LINK E5 TO E4**

- 4.1 Work involves the full closure of Southern Parallel Taxiway for the duration of the rehabilitation works.
- 4.2 Works at Southern Parallel Taxiway Stage 1 and Stage 2 must be completed before Stage 3 can be started. During Stage 1 and Stage 2, takeoff from Runway 03 will be either from runway intersection E3 or intersection E4 or 180 turn at Turn pad Runway 03.
- 4.3 Construction works will be carried out in 24 hours within the closed area.
- 4.4 The affected area will be permanently cordoned/barricaded for construction works and lit at night.

##### **STAGES 2: SOUTHERN PARALLEL TAXIWAY LINK E4 TO EG2**

- 4.5 Work involve full closure of the affected area for the duration of the rehabilitation works continuing from Stage 1 up to Taxiway Link EG 2
- 4.6 Construction works will be carried out in 24 hours within the closed area.
- 4.7 The affected area will be permanently cordoned/barricaded for construction works and lit at night.

##### **STAGES 3: TAXIWAY LINK EG1 TO SOUTHERN PARALLEL TAXIWAY LINK E3**

- 4.8 Taxiway Link E3 and EG1 will be closed during this stage.
- 4.9 Taxiway link E4 to E5 will be accessible via EG2.
- 4.10 Construction works will be carried out in 24 hours within the closed area.
- 4.11 The affected area will be permanently cordoned/barricaded for construction works and lit at night.

##### **STAGES 4: WESTERN PARALLEL TAXIWAY NEAR TAXIWAY LINK W2**

- 4.12 Taxiway link W2 will be closed during the stage.
- 4.13 During this time, take off from Runway 21 will be via Northern Parallel Taxiway.

## **5. MOVEMENT AREA RESTRICTIONS**

- 5.1 The restricted and available movement areas during the work in progress for each work stage will be as Attachment 2 and changes notified and circulated by NOTAM with reference to this supplement.

## **6. REGULATIONS ON MANEUVERING MOVEMENT AREAS**

- 6.1 No aircraft movement is allowed on the closed portions of taxiways and taxiway links.
- 6.2 The routes to be used by aircraft when taxiing into, in and out of the Apron will be specified by Air Traffic Control. The issuance by Air Traffic Control instructions for a taxi route to an aircraft does not relieve the pilot-in-command of the responsibility to maintain separation with other aircraft on the maneuvering movement area or to comply with Air Traffic Control directions intended to regulate aircraft movement.

## **7. PRECAUTIONS**

- 7.1 During the construction period, pilots are advised to take note of the precautions on the presence of open excavation, workers construction materials and construction equipment, particularly when backtracking on the runway at Turn pad 03.

## **8. IMPLEMENTATION**

- 8.1 This AIP Supplement and relevant charts is applicable during the whole of the rehabilitation work in progress.
- 8.2 Trigger NOTAM will be issued notifying the effective date of implementation.

## **9. CANCELLATION**

- 9.1 This AIP Supplement will remain current until the information is published in AIP Brunei.

## **10. CONCLUSION**

- 11.1 Any changes to the contents of the AIP Supplement will be notified through NOTAM.

**MOHAMAD AZLAN MOHAMMAD JUNAIDI**  
**Director of Civil Aviation**  
**Department of Civil Aviation**  
**Brunei Darussalam**

## BRUNEI INTERNATIONAL AIRPORT AIRFIELD PAVEMENT REHABILITATION CONSTRUCTION WORKS AREAS - PHASE 2

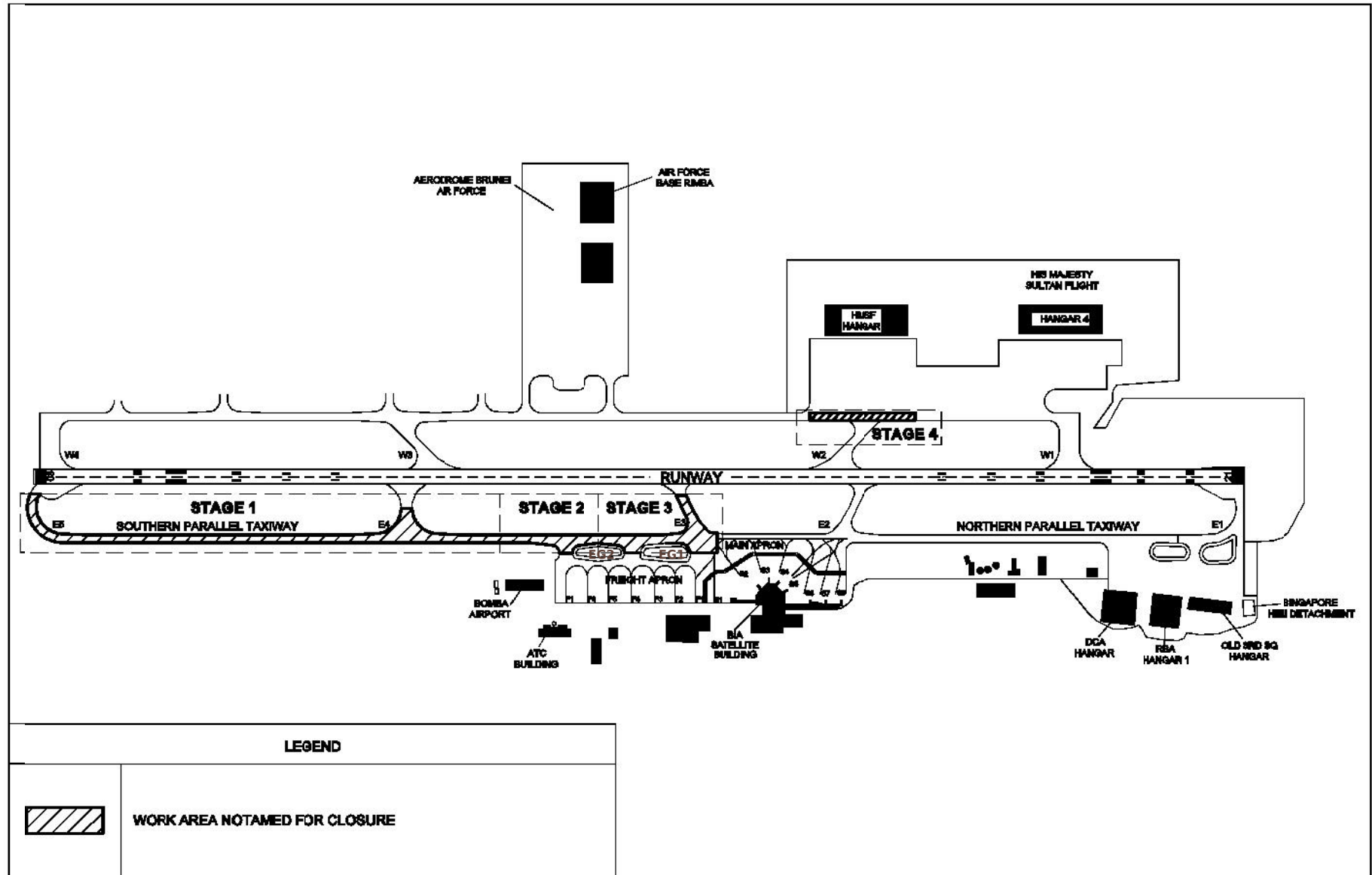

Stages	Activity	Temporary Procedures	
		Arrival	Departure
Stages 1 & Stages 2	Southern Parallel Taxiway - Taxiway Link E5 to Taxiway Link E4  Taxiway E4 Link to EG 2	<p>1. <b>Rwy 03</b> to clear rwy via E1, E2 or E3</p> <p>2. <b>Rwy 21</b> to backtrack on the rwy or clear rwy via W3 and W4</p>	<p><b>Rwy 03 :</b> a/ S1,S2 &amp; S3 i/ To push back towards Point T1 or T2 or T3 face North or South and to taxi via E3 and backtrack Rwy 03 or utilizing Western Parallel Twy between W3 and W4.</p> <p>b/ S4,S5,S6,S7 &amp; S8 ii/ To push back towards Point T3 or T4 or T5 face South and to taxi via E2 or E3 and backtrack Rwy 03 or utilizing Western Parallel Twy between W3 and W4.</p> <p><b>Rwy 21 :</b> a/ S1,S2 &amp; S3 i/ To push back towards Point T1 or T2 or T3 face North and to taxi via E1 or E2.</p> <p>b/ S4,S5,S6,S7 &amp; S8 ii/ To push back towards Point T3 or T4 or T5 face north and taxi via E1 or E2</p>
Stages 3	EG1 to Taxiway Link E3	<p>1. <b>Rwy 03</b> to clear runway via E1 or E2</p> <p>2. <b>Rwy 21</b> to clear runway via E4 or E5, SPT, EG2</p>	<p><b>Rwy 03 :</b> a.<b>S1, S2 &amp; S3</b> i/ To push back towards Point <b>T2 or T4</b> face south and to taxi via EG2, Southern Parallel Twy E4 or E5 or Western Parallel Twy W3 or W4</p> <p>b.<b>S4, S5, S6, S7 &amp; S8</b> ii/ To push back towards Point <b>T4 or T5</b> face South and to taxi via E2 backtrack on rwy or via W3, Western Parallel Twy or via EG2 , Southern Parallel Twy ,E4 or E5</p> <p><b>Rwy 21 :</b> a.<b>S1, S2 &amp; S3</b> i/ To push back towards Point <b>T2 or T4</b> face North and to taxi via E1 or E2.</p> <p>b.<b>S4, S5, S6, S7 &amp; S8</b> ii) To push back towards Point <b>T4 or T5</b> face north and to taxi via E1 or E2</p>

**Note : For All procedures to follow ATC instructions.**

**The closed area concerned are marked with red/white barricades and lit with obstruction lights at night.**

**BRUNEI INTERNATIONAL AIRPORT AIRFIELD PAVEMENT REHABILITATION WORK LAYOUT  
STAGE 1 SOUTHERN PARALLEL TAXIWAY LINK E5 to E4**

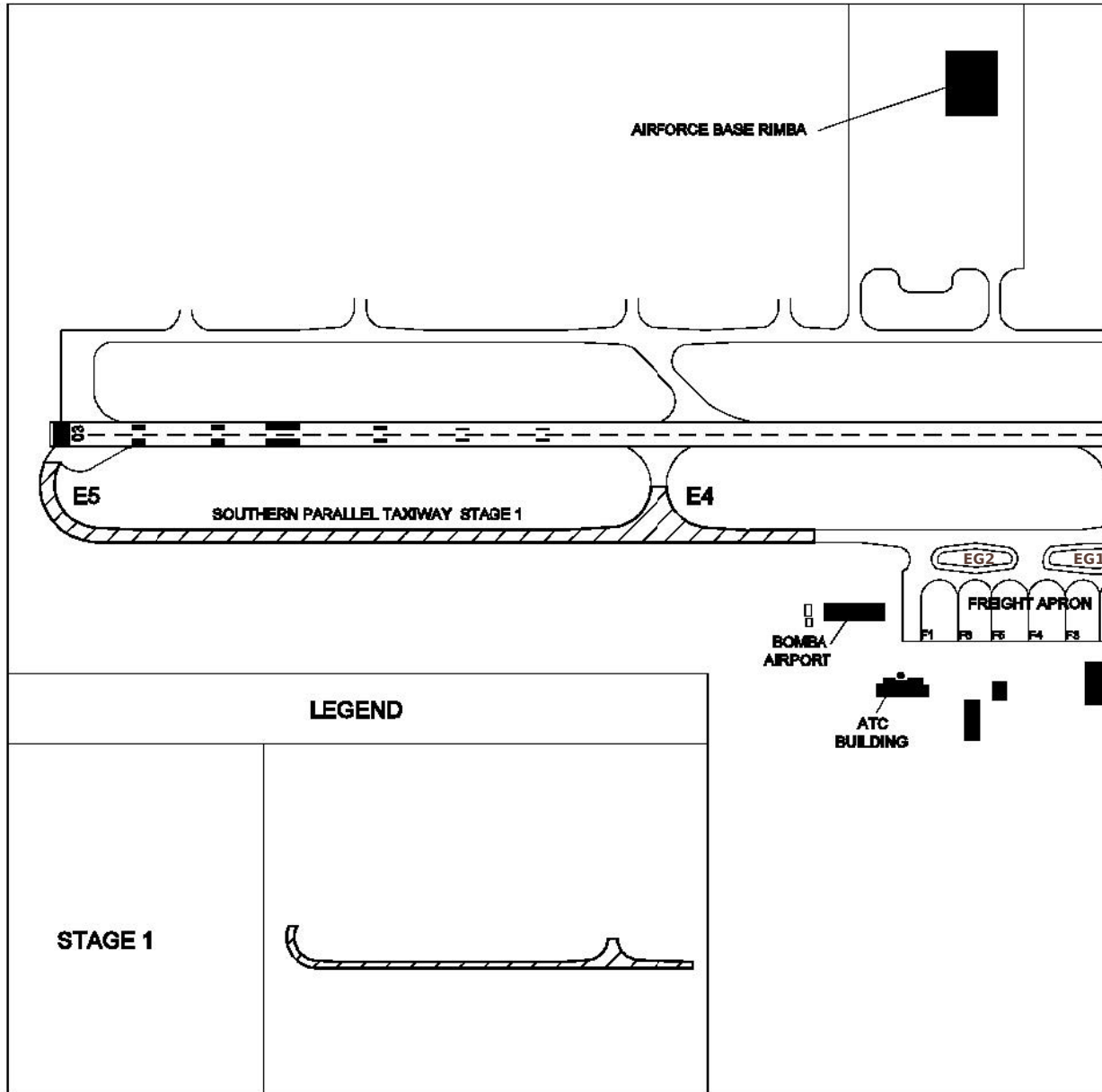

**BRUNEI INTERNATIONAL AIRPORT AIRFIELD PAVEMENT REHABILITATION WORK LAYOUT  
STAGES 2 TAXIWAY E4 LINK EG 2**

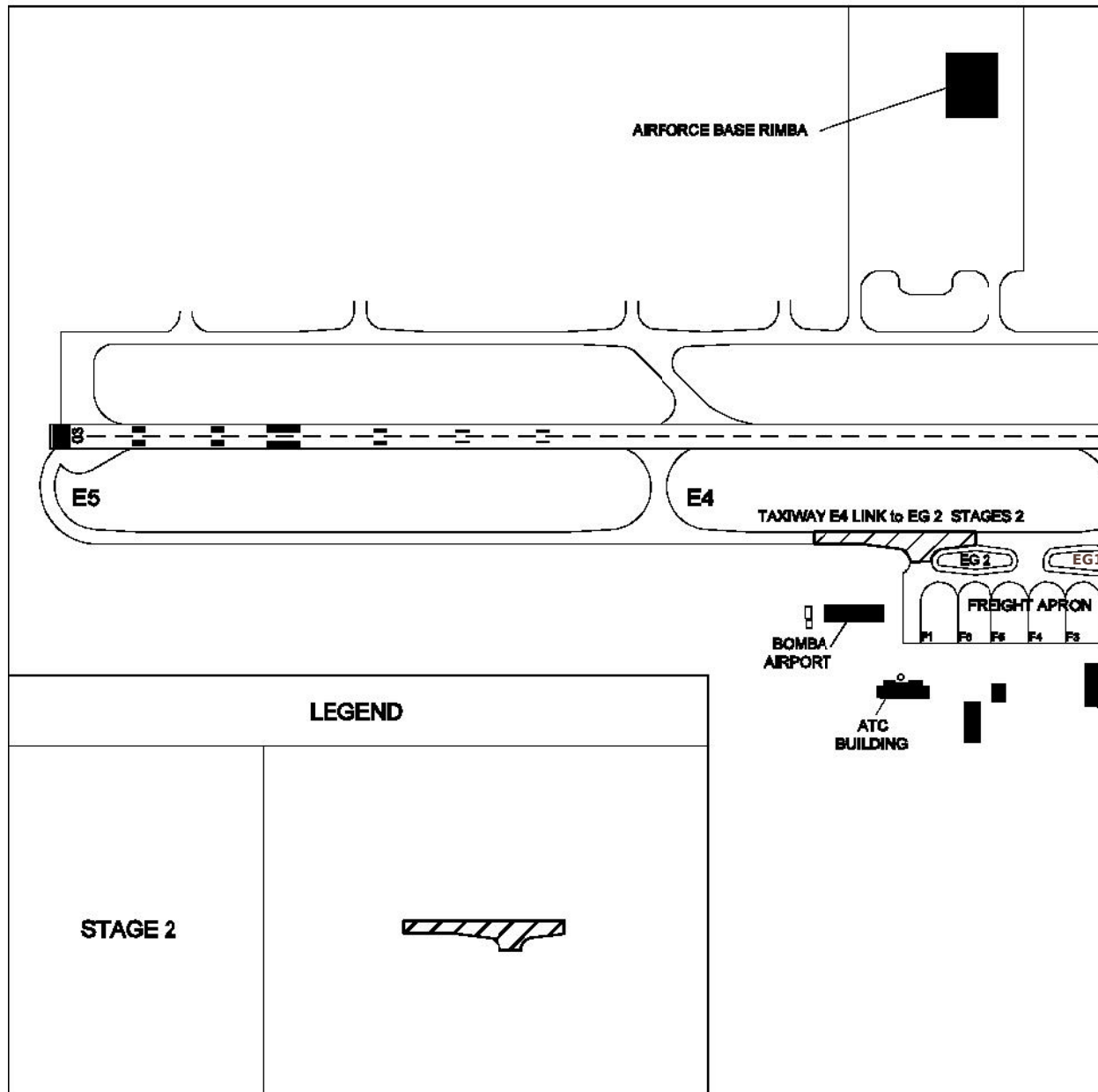



**BRUNEI INTERNATIONAL AIRPORT AIRFIELD PAVEMENT REHABILITATION WORK LAYOUT  
STAGES 3 TAXIWAY EG1 TAXIWAY LINK E3**

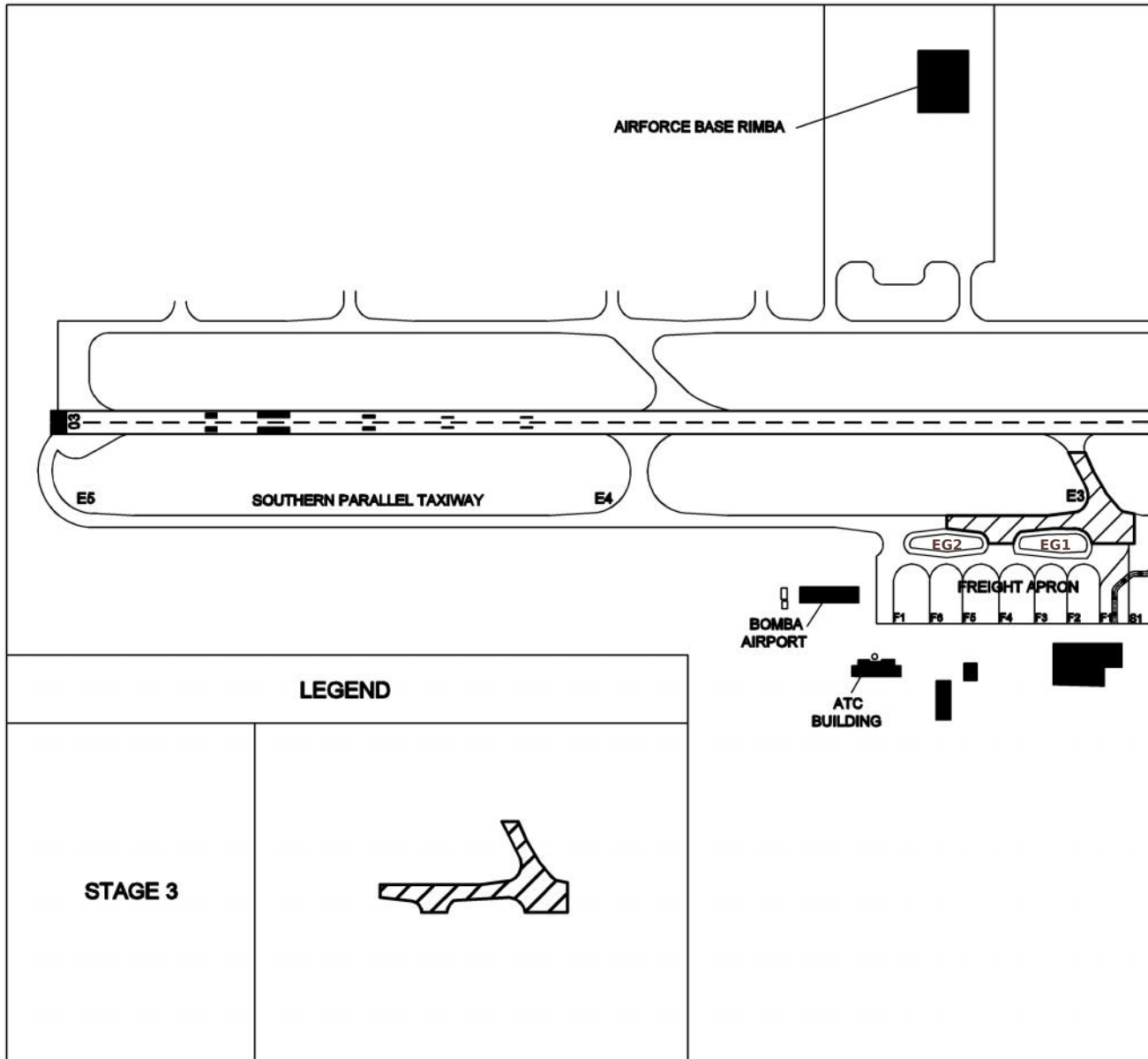

**BRUNEI INTERNATIONAL AIRPORT AIRFIELD PAVEMENT REHABILITATION WORK LAYOUT  
STAGES 4 WESTERN PARALLEL TAXIWAY NEAR TAXIWAY LINK W2**

